

# VacuLUX

HVE ISOLATION SYSTEM



INSTRUCTIONS FOR USE

## TABLE OF CONTENTS

### Section 1: VacuLUX™ Isolation System

Intended Use	2
Product Contents	3
Cleaning & Sterilization	3
Installation of Chairside System	4
Installation of Portable System	4
Maintenance	5
Warnings & Precautions	5

### Section 2: VacuLUX™ Mouthpieces

Features of the Mouthpiece	6
Intended Use	6
Mouthpiece Sizing	6
Connecting Mouthpieces	7
Mouthpiece Placement & Removal	7
Autoclavable Mouthpiece Sterilization	8
Warnings & Precautions	8

## SYMBOLS GLOSSARY

					
Caution	Non-Sterile	Do not use if package is damaged	Consult instructions for use	Catalog number	Single-Use Only

## INSTRUCTIONS FOR USE



### SECTION 1

## VacuLUX™ Dental Isolation System

### INTENDED USE

The VacuLUX™ is a dental isolation adapter for clinical use by dental professionals. The adapter is designed to connect standard high volume evacuation valves to isolation mouthpieces for the purpose of control of the oral environment by isolating two quadrants while simultaneously providing tongue and cheek retraction and continuous high-volume suction.

## PRODUCT CONTENTS



### VacuLUX™ Chairside Isolation System

[REF] CVAIRV, CVAIRD, CVAIRZ

#### Includes:

VacuLUX™ HVE Adapter

[REF] VAIRV, VAIRD, VAIRZ

VacuValve™ HVE Lite

[REF] VVL

Whisper Lite™ Hose

[REF] WLH

HVE Y Adapter

[REF] YADP

Service Kit

[REF] SRVK



#### Accessories Sold Separately:

Autoclavable Mouthpieces

[REF] AVLUXP (4 Pack, Size Pedro)

[REF] AVLUXS (4 Pack, Size Small)

[REF] AVLUXM (4 Pack, Size Medium)

[REF] AVLUXL (4 Pack, Size Large)

[REF] AVLUXA (4 Pack, Assorted Sizes)

### VacuLUX™ Portable Isolation System

[REF] PVAIRV, PVAIRD, PVAIRZ

#### Includes:

VacuLUX™ HVE Adapter

[REF] VAIRV, VAIRD, VAIRZ

Feather Flex™ Kit

[REF] FFKS

Service Kit

[REF] SRVK



#### Single-Use Mouthpieces

[REF] SVLUXP (20 Pack, Size Pedro)

[REF] SVLUXS (20 Pack, Size Small)

[REF] SVLUXM (20 Pack, Size Medium)

[REF] SVLUXL (20 Pack, Size Large)

#### HVE Valve Maintenance Kit

[REF] HVEMK

## CLEANING & STERILIZATION

### VacuLUX™ HVE Adapter & VacuValve™ HVE Lite

#### CLEANING:

Use a stiff brush and mild detergent to clean internal surfaces. The VacuValve™ HVE Lite can be disassembled for easier access to interior. See disassembly instructions on page 4.

#### DISINFECTING:

Run the VacuLUX™ HVE Adapter and the VacuValve™ HVE Lite with a non-corrosive, pH-neutral enzymatic cleaning solution. Disconnect the VacuLUX™ HVE Adapter from the VacuValve™ HVE Lite and perform a thorough surface disinfection with a disinfectant wipe.

#### STERILIZING:

Products should be cleaned as soon as possible after use to prevent soils from hardening. Remove all visible debris prior to sterilizing. Process product through steam autoclave following the autoclave manufacturer's instructions. Do not exceed a temperature of 132°C/270°F. 6 minutes holding time, minimum. Avoid contact of sterilizer wall and avoid close proximity to heating elements. Store only in FDA approved sterilization pouch.

### Whisper Lite™ Hose & Feather Flex™ Kit

**DO NOT AUTOCLAVE.** Run the Whisper Lite™ or Feather Flex™ hose with a non-corrosive, pH-neutral enzymatic cleaning solution and perform a surface disinfection with a hospital grade disinfectant wipe between each patient.

## INSTALLATION OF THE CHAIRSIDE SYSTEM (Y ADAPTER)

For an additional High-Volume evacuation line for the VacuLUX™ Isolation System, and for easily accessible valve control during your procedures, install the Chairside System with the VacuValve™ HVE Lite.

- Step 1.** Disconnect your standard HVE vacuum line from your vacuum canister's port.
- Step 2.** Connect the Y Adapter Tube to your vacuum canister's port.
- Step 3.** Attach your standard HVE vacuum line to one end of the Y Adapter.
- Step 4.** Attach the Whisper Lite™ Hose to the other end of the Y Adapter.
- Step 5.** Dock the VacuValve™ HVE Lite on the docking station.
- Step 6.** Connect your VacuLUX™ HVE Adapter to the VacuValve™ HVE Lite.

The VacuValve™ HVE Lite can be used with other HVE instruments, including Ascentcare's VacuVUE™ HVE Mirror or any standard HVE suction straw.

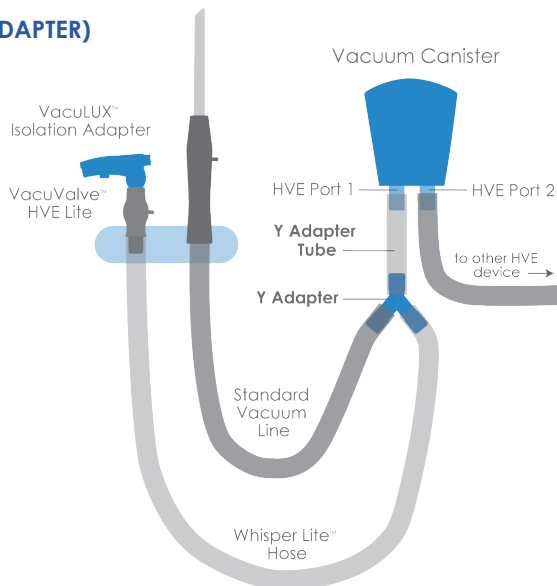

## INSTALLATION OF THE PORTABLE SYSTEM (FEATHER FLEX KIT)

For quick and easy portability from one room to the next, and for a quieter, more comfortable patient experience, install the Portable System with the lightweight Feather Flex™ Kit.

- Step 1.** Connect your VacuLUX™ HVE Adapter to the aluminum instrument coupler.
- Step 2.** Connect your HVE Valve to the curved stainless steel tube.
- Step 3.** Dock your HVE Valve at your docking station.
- Step 4.** When not in use, rest the hose in the hose clip to securely hold your VacuLUX™ HVE Adapter.

The Feather Flex™ Kit's instrument coupler can also be used for other HVE instruments including standard HVE suction straws and Ascentcare's VacuVUE HVE™ Mirror.

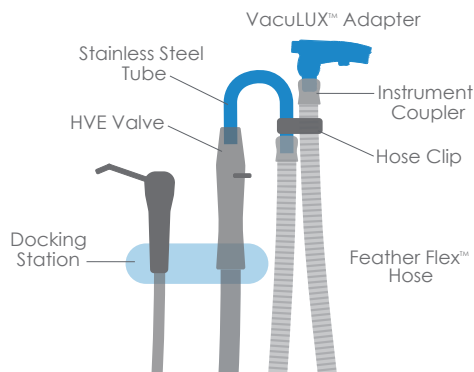

## MAINTENANCE

With regular use, cleaning & maintenance, the VacuValve™ HVE Lite, Feather Flex™ Kit and VacuLUX™ Isolation Adapter were designed to last.

### VacuValve™ HVE Lite

To ensure smooth lever action and quick disconnect swivel, lubricate all valve O-rings\* regularly.

Replace any O-ring that becomes worn, nicked, or cut. Please see the reference numbers below for replacement O-rings.

#### Tip O-Rings

 ORING-TP

#### Swivel O-Ring

 ORING-SW

#### Spool O-Rings

 ORING-SP

### Feather Flex™ Kit

To ensure easy coupling and a secure hold of the VacuLUX™ HVE Adapter, regularly lubricate the O-Ring\* and replace as needed.

### VacuLUX™ HVE Isolation Adapter

The VacuLUX™ HVE Adapter has a one-piece design for easy cleaning and does not require maintenance.

However, to use the VacuLUX™ HVE Adapter with your existing standard HVE Valve, **maintenance to your valve is required.** The VacuLUX™ adapter was designed to be held in place and to swivel on your valve's O-ring. Over time, these O-rings can deteriorate and often fall out. Check your HVE valve's O-ring and replace if needed. Regularly lubricating the O-ring will also extend its life and make for easier instrument coupling.\*

#### To replace your valve's O-ring:

- Step 1.** Use a tool such as a small scaler to remove and discard the old O-ring.
- Step 2.** Fold the new O-ring in half and insert it into your valve.
- Step 3.** Working it around in a circular pattern, lever the O-ring into the groove with your tool. Ensure the O-ring is fully seated in the groove.

\*Always use silicone-based lubricants. O-Ring Lubricant is included with purchase & available in Ascentcare's HVE Valve Maintenance Kit:

 HVEMK

### VacuValve™ HVE Lite Diagram

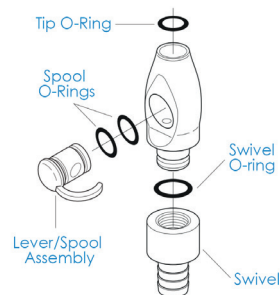

## ISOLATION SYSTEM WARNINGS & PRECAUTIONS



**WARNING:** Sterilize all products before use according to sterilization instructions.



**WARNING:** Do not use products if the device package seal is broken, open or damaged.



**WARNING:** Do not use if there is a tear, fracture or breakage in the mouthpiece or system hoses.



**WARNING:** Be sure to use established protocols and patient monitoring when using the Mouthpiece in conjunction with sedation dentistry. Patient management by a certified anesthesiologist is strongly recommended.



**CAUTION:** Do not use VacuLUX™ system until you have reviewed the user guide on how to install the system, select and place the mouthpiece, and clean and sterilize the components.



**CAUTION:** When performing dental procedures requiring high levels of blood evacuation, it is recommended that the Mouthpiece be intermittently flushed with water to prevent coagulation in the Mouthpiece to avoid loss of suction and light transmission.



**CAUTION:** Do not autoclave the VacuLUX™ Adapter or VacuValve™ HVE Lite at temperatures above 132 C as it may cause damage.



**CAUTION:** Failure to maintain properly lubricated O-rings can result in damage to the VacuValve™ HVE Lite that is not covered by the product warranty.



**CAUTION:** Do not step on, crimp, or fold the suction hose in any way as that could cause loss of suction power.



**CAUTION:** Check the devices for wear prior to use to make sure that it is adequate for use.



## SECTION 2

# VacuLUX™ Isolation Mouthpieces

### INTENDED USE

The VacuLUX™ Mouthpiece is intended for use by dental professionals for isolation, bite block, cheek retractor, tongue guard and high-volume evacuation.

### MOUTHPIECES SOLD SEPERATELY

Please see complete instructions for use included with the purchase of your VacuLUX mouthpieces. Complete instructions are also available at: [www.AscencareDental.com/product-instructions](http://www.AscencareDental.com/product-instructions)

#### AUTOCCLAVABLE MOUTHPIECES

Autoclavable mouthpieces are available in packs of 4 with five sizing options:

Autoclavable Mouthpiece Pedo 4-pack

**REF** AVLUXP

Autoclavable Mouthpiece Small 4-pack

**REF** AVLUXS

Autoclavable Mouthpiece Medium 4-pack

**REF** AVLUXM

Autoclavable Mouthpiece Large 4-pack

**REF** AVLUXL

Autoclavable Mouthpiece Assorted 4-pack

**REF** AVLUXA

#### SINGLE-USE MOUTHPIECES

Single-Use mouthpieces are available in packs of 20 with four sizing options:

Single-Use Mouthpiece Pedo 20-pack

**REF** SVLUXP

Single-Use Mouthpiece Small 20-pack

**REF** SVLUXS

Single-Use Mouthpiece Medium 20-pack

**REF** SVLUXM

Single-Use Mouthpiece Large 20-pack

**REF** SVLUXL

### MOUTHPIECE SIZING

To select the correct mouthpiece size, measure the patient's interincisal opening. If between sizes, we recommend selecting the smaller size.

Approximate Mouthpiece Size Guide by Interincisal Opening Measurements:

Pedo (AVLUXP, SVLUXP): < 30 mm

Small (AVLUXS, SVLUXS): 30 mm

Medium (AVLUXM, SVLUXM): 30-45 mm

Large (AVLUXL, SVLUXL): > 45 mm



## CONNECTING MOUTHPIECES

VacuLUX™ Adapters are designed to fit VacuLUX™ mouthpieces as well as **Dryshield** and **Isolite** mouthpieces.

Slide the mouthpiece onto the device until the locking post(s) engage. To ease attachment, **use water or mouthpiece lubricant** to lubricate the inside surface of the mouthpiece sleeve.



Locking posts for VacuLUX™  
& **Isolite** brand mouthpieces

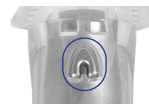

Locking post for VacuLUX™  
& **Dryshield** brand mouthpieces

## MOUTHPIECE PLACEMENT

Moisten the mouthpiece and the patient's lips with water prior to placing the mouthpiece within the oral cavity.



**Step 1:** Hold the sides of the isolation adapter with your index finger and thumb. With your other hand, fold the cheek retractor onto the tongue guard. Then fold the outside edges of the mouthpiece towards the center.



**Step 2:** Gently insert the mouthpiece, lining up the bite-block onto occlusal surfaces of the teeth, just distal to the mandibular cuspid. Instruct patient to rest their jaw on the bite block to secure.



**Step 3:** Place the cheek retractor into the buccal vestibule. Adjust the tongue guard in the lingual vestibule as needed. Move the bite block distally to provide more vertical working room. Reposition the patient's lips as needed.

## MOUTHPIECE REMOVAL

To remove the mouthpiece, instruct the patient to open wide. Gently pull out the adapter and mouthpiece together.

For videos demonstrating mouthpiece sizing, placement and removal, visit: [www.AscentcareDental.com/videos-isolation](http://www.AscentcareDental.com/videos-isolation)

## AUTOCLAVABLE MOUTHPIECE CLEANING & STERILIZATION

The Autoclavable VacuLUX™ mouthpiece was engineered for efficient & effective cleaning. Simple-Sterile technology includes:

- Open flaps for easy access to mouthpiece interior
- One piece design requiring no disassembly and reassembly
- Solid bite block & limited crevices to prevent debris build-up

**WARNING:** Single-use mouthpieces (marked "SINGLE-USE ONLY") cannot be sterilized or reused. Autoclavable mouthpieces must be sterilized prior to use and between patients.

- Step 1:** While still attached to the HVE line, thoroughly rinse the mouthpiece using your air/water syringe, or by placing in a cup of water.
- Step 2:** Remove the mouthpiece from the adapter and place it in your Ultrasonic Cleaner for 15 minutes.
- Step 3:** Thoroughly scrub the mouthpiece with a detergent solution or soap and water, using a brush to reach inside flap openings and mouthpiece connector region.
- Step 4:** Rinse under running water, air-dry, and place inside autoclave pouch for sterilization.
- Step 5:** Sterilize in a steam-autoclave machine at a minimum of 121° C / 250° F for a minimum of 30 minutes. Do not exceed a temperature of 134° C / 273° F.
- Step 6:** Allow for a 30 minute minimum drying cycle.





To extend the life of your mouthpiece, do not let debris sit in the mouthpieces. Flush the mouthpieces immediately after use and bring to your sterilization room for cleaning as soon as possible.

## ISOLATION MOUTHPIECES WARNINGS & PRECAUTIONS



 **WARNING:** Consult instructions for use from the user guide prior to use.

 **WARNING:** Do not use products if the device package seal is broken, open or damaged.

 **WARNING:** Do not cold sterile or use surface disinfectants on the mouthpiece. All autoclavable mouthpieces must be cleaned and autoclaved after each use.

 **WARNING:** Do not re-use single-use mouthpieces. Re-use can result in the transmission of infectious pathogens.

 **WARNING:** Be sure to use established protocols and patient monitoring when using the Mouthpiece in conjunction with sedation dentistry. Patient management by a certified anesthesiologist is strongly recommended.

 **CAUTION:** Check the devices for wear prior to use to make sure that it is adequate for use.

 **CAUTION:** Do not overextend the mouthpiece opening or flaps as it may tear or break it.

 **NON-STERILE**

## CUSTOMER SUPPORT

For information on the VacuLUX™ Isolation system & Autoclavable Mouthpieces, including instructional videos and more, visit [www.AscentcareDental.com](http://www.AscentcareDental.com)

Ascentcare guarantees all products to be free of manufacture defects. In the unfortunate case that a problem should occur, your VacuLUX™ Isolation System is covered under a limited warranty for a period of 1 year. For more information & to register your products, visit [www.AscentcareDental.com/warranty](http://www.AscentcareDental.com/warranty)

(616) 600-4505 | [support@ascentcaredental.com](mailto:support@ascentcaredental.com)



Manufactured by:  
Ascentcare Dental Products, Inc.  
335 North Griffin Street  
Grand Haven, MI 49417