



Practicon® BrushTip™ Ultrasonic Insert

70-01733

Contents:

(1) 30kHz BrushTip Ultrasonic Insert • (1) BrushTip Wrench

Manufactured for

PRACTICON
PRACTICAL INNOVATIONS FOR DENTISTRY

1-800-959-9505 • Fax 1-800-278-0885
practicon.com • Greenville, NC 27834
Assembled in USA • IFU 7001733_2



**Read instructions before use.
Save for future reference.**



**DO NOT OPERATE BrushTip Ultrasonic
Insert without a brush tip in place.**

US Patent Pending



723896023594

Instructions for Use

Thank you for purchasing the **BrushTip Ultrasonic Insert**.

Designed to accept disposable, screw-in prophylaxis brush tips, it is ideal for use around implants, ortho brackets, crowns and bridges, sensitive teeth, and soft enamel. Use prior to scaling for heavy plaque removal and on patients who dislike traditional polishing. Fits all standard magnetostrictive ultrasonic scaler units. Brush tips sold separately. **For professional use only.**

1. Before installing BrushTip Ultrasonic Insert into unit, grip insert securely and screw brush tip in clockwise. Tighten brush tip firmly with fingers. Hand tighten only (Figure 1).
2. Snug brush tip into place using special wrench included. Press mouth of wrench onto cylindrical body of brush tip and apply gentle clockwise pressure. Do not rotate tip any further (Figure 2). **DO NOT** overtighten.
3. Check for proper tightness of brush tip with fingers. If brush tip becomes loose, stop immediately and repeat step 2.
4. After attaching brush tip, install insert into unit. Once secured, power unit on and adjust water to reduce excess flow. **DO NOT OPERATE** insert without a brush tip in place.
5. Once water and power have been set, clean in a circular motion to loosen plaque and debris along gumline and tooth surfaces.
6. Remove and dispose of brush tip after each patient (Figure 3).
7. Remove, clean, and sterilize insert (instructions on reverse).

Troubleshooting Tips:

- If brush tip will not screw into insert, do not force. Flush brush tip receiver with A-W syringe to remove any internal debris and try again.
- If water drips excessively from brush tip, reduce water flow setting until dripping stops.
- An audible vibration during operation may indicate a loose brush tip. If brush tip becomes loose, stop immediately and repeat step 2 above.
- If brush head breaks off due to overtightening, remove broken threads by doing the following:
 - a. Install insert into ultrasonic unit.
 - b. With water flow on high, operate unit on high power until broken threads begin to vibrate out of insert.
 - c. Once visible, use forceps to grasp end of broken threads and turn threads out by hand.

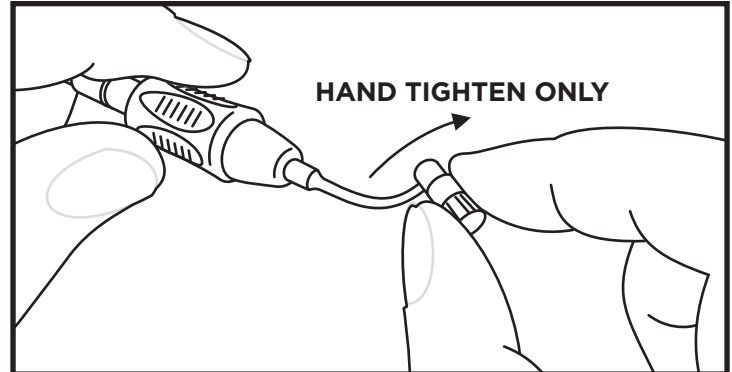

Figure 1. Grip insert securely and screw brush tip in firmly. **HAND TIGHTEN ONLY.**

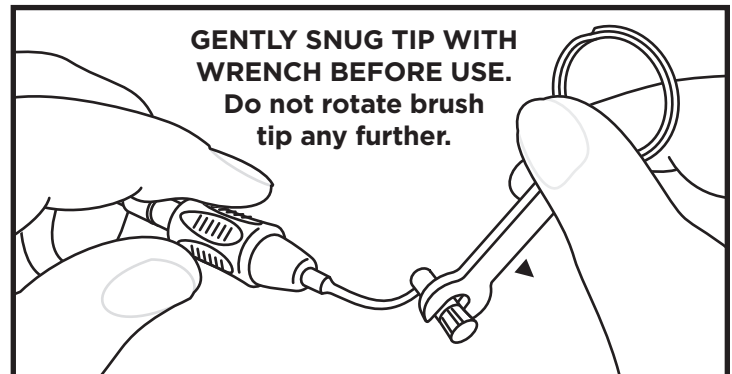

Figure 2. Snug brush tip with wrench. **DO NOT OVERTIGHTEN.**

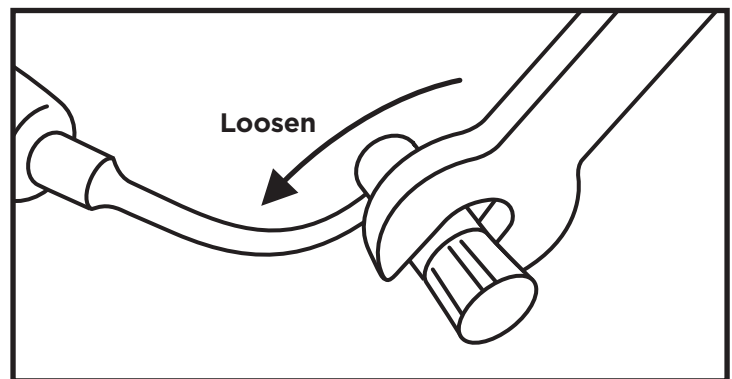

Figure 3. Remove and dispose of brush tip after each patient.



**DO NOT OPERATE BrushTip Ultrasonic
Insert without a brush tip in place.**

BrushTip™ Ultrasonic Insert

Cleaning and Sterilization Guidelines

Proper cleaning and care will help extend the life of your **BrushTip Ultrasonic Insert**.

- **Cleaning:** Rinse insert thoroughly or fully immerse in a mild ultrasonic cleaning solution. Insert may be placed in an ultrasonic cleaning unit for 7–10 minutes or 16–20 minutes if the insert is in a cassette.
- **Rinsing:** Thoroughly rinse with tap water and dry completely prior to sterilization.
- **Sterilization:** Sterilize insert in an instrument cassette or paper pouch in a steam autoclave. Steam sterilize for at least 4 minutes at 270°F/132°C or 30 minutes at 250°F/121°C. Do not heat above 275°F/135°C.
- **Drying:** 30 minutes of drying time after steam sterilization is recommended prior to use.

Can I put the BrushTip Ultrasonic Insert in an ultrasonic cleaner?

Ultrasonic inserts may be cleaned in an ultrasonic cleaning unit with a mild ultrasonic solution. The mild ultrasonic solution will not harm the insert and neither will the cavitation produced by the ultrasonic cleaning unit.

I thought an ultrasonic cleaner would ruin my insert?

The mild ultrasonic solution and cavitation produced by the ultrasonic cleaning solution will not harm the insert. Inserts can be damaged in the ultrasonic cleaner when they are mishandled or placed under other instruments. The weight of instruments resting on top of an insert can cause the stack to deform. An insert stack that is deformed, warped, or bent will result in reduced function of the insert.

What is the best way to place my insert in the ultrasonic cleaner?

Ideally, inserts should be placed in an instrument cassette where the outer wall of the cassette will provide superior protection from the weight or intrusion of other instruments. If cassettes are not used, carefully place the insert in the ultrasonic cleaner either alone or in a location where it will not be subject to the weight of other dental instruments.

Can I wipe down or spray the insert with a surface disinfectant?

Do not use chemical or surface disinfectants as deterioration of the material may occur. Avoid contact with corrosive chemicals such as bleach, phenols, and hydrogen peroxide. Cold sterilization chemicals are also not recommended for use with any ultrasonic insert.

Accessories and Replacement Parts

Only use original Practicon components/accessories.

Item Number	Description	Details
70-01733	BrushTip Ultrasonic Insert	30kHz
70-01734	BrushTip Ultrasonic Insert Starter Kit	Includes BrushTip Ultrasonic Insert, BrushTip Wrench, and 100 brush tips
70-01735	BrushTip Refills	100 brush tips in assorted colors
70-01736	BrushTip Wrenches	Three per box with split key ring

Manufactured for

US Patent Pending